



INSTALLATION INSTRUCTIONS

Accessory
XM RADIO SYSTEM

Application
**2010 CIVIC
2-AND 4-DOOR (Si)**

Publications No.
All 42482

Issue Date
AUG 2009

PARTS LIST

**XM Radio Attachment (sold separately):
P/N 08B15-SNA-100B**

Bus cable

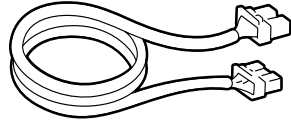

Front bracket

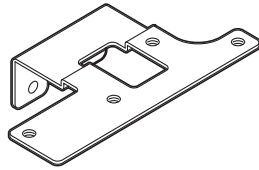

Rear bracket

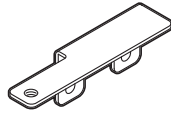

Clip



4 Pan screws

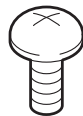

4 Washers



3 Flange bolts

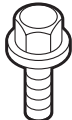

Cover seal

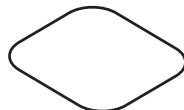

20 Wire ties
(2 Not used)

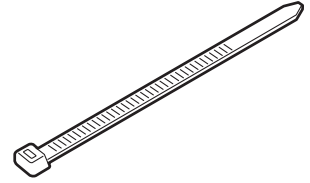

7 Wire ties with clip
(Some may not be used.)

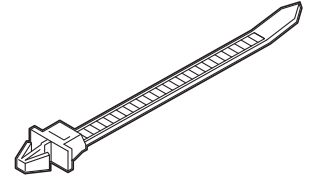

12 Cushion tapes
(Some may not be used.)



8 EPT sealers
(Some may not be used.)

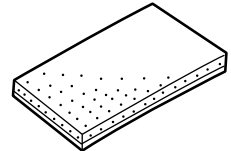

**XM Antenna (sold separately):
P/N 08A15-0J1-100**

Antenna assy

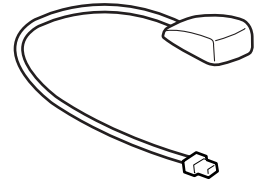

**Unit (sold separately):
P/N 08A15-3J1-000**

XM radio unit

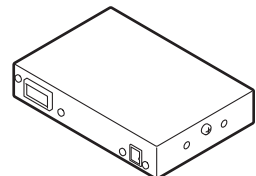

**2-Port Bus Cable (sold separately):
P/N 08A31-0F1-000**

2-Port bus cable

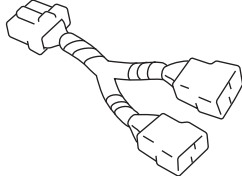

TOOLS AND SUPPLIES REQUIRED

- Phillips screwdriver
- Flat-tip screwdriver
- Ruler
- Shop towel
- Scissors
- Ratchet
- 10 mm Socket
- 10 mm Combination wrench
- Isopropyl alcohol
(Isopropyl alcohol, in a 60/40 solution with water)
- Rubber mallet
- Masking tape
- Diagonal cutters
- Plastic Trim Tool (T/N SILTRIMTL10)
- TORX bit

Illustration of the XM Radio System Installed on the Vehicle

2-door vehicle:

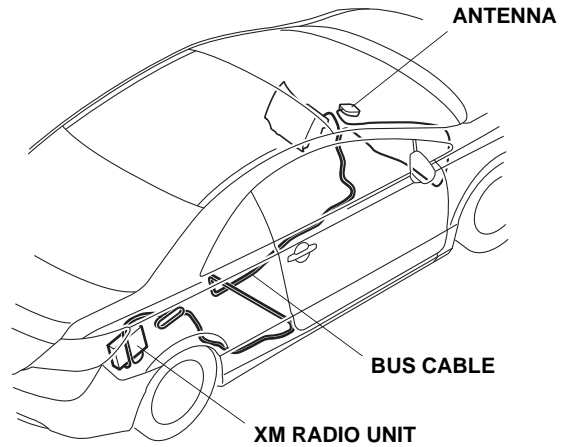

4-door vehicle:

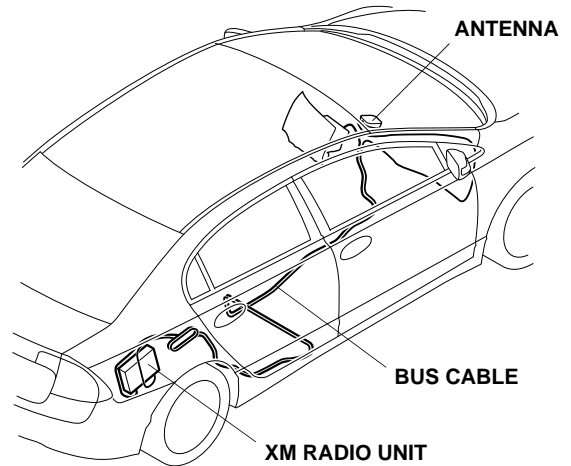

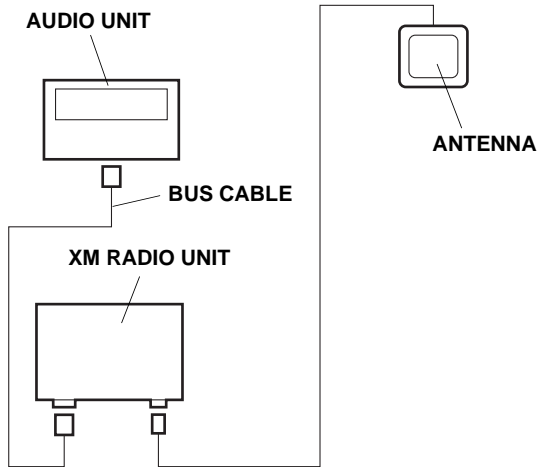

INSTALLATION

Customer Information: The information in this installation instruction is intended for use only by skilled technicians who have the proper tools, equipment, and training to correctly and safely add equipment to your vehicle. These procedures should not be attempted by “do-it-yourselfers.”

1. Make sure you have the anti-theft codes for the audio and navigation system (if equipped), then write down the audio presets.
2. Disconnect the negative cable from the battery.
3. Remove the passenger's dashboard lower cover (four clips and two pins).

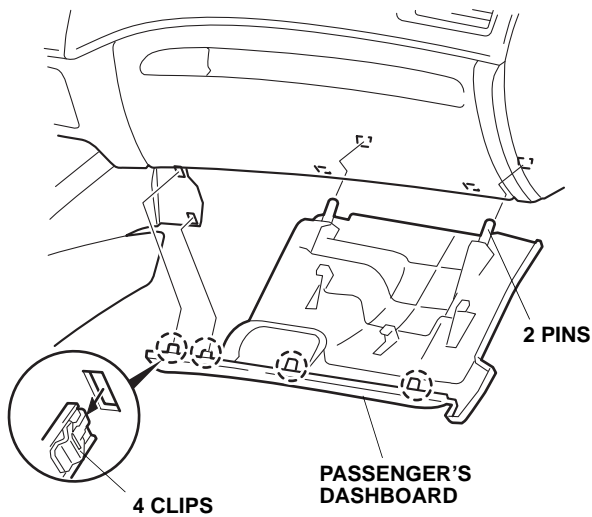

4. Remove the two bolts under the glove box.

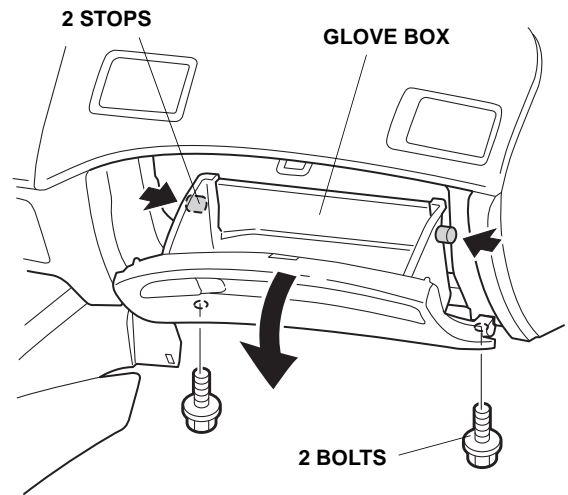

5. Open and remove the glove box (two stops).
6. Remove the driver's dashboard lower cover (eight clips).

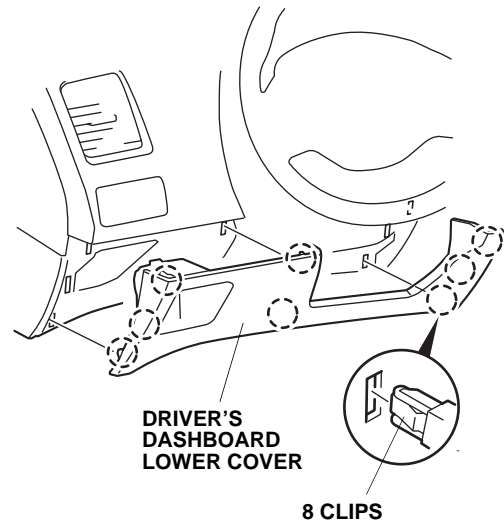

- Remove the inside cover from the front console pocket (two tabs).

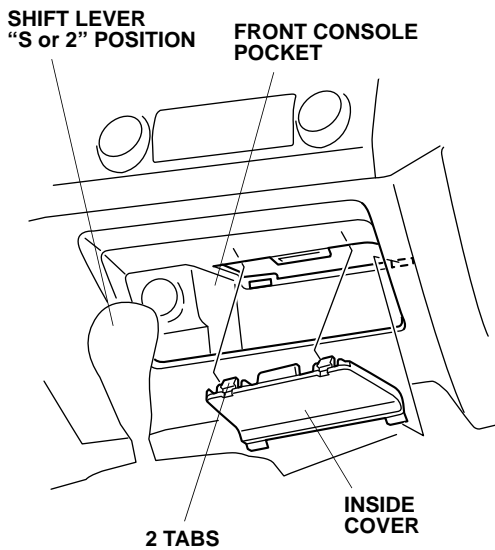

- Lower the tilt lever, then pull the steering wheel toward you.

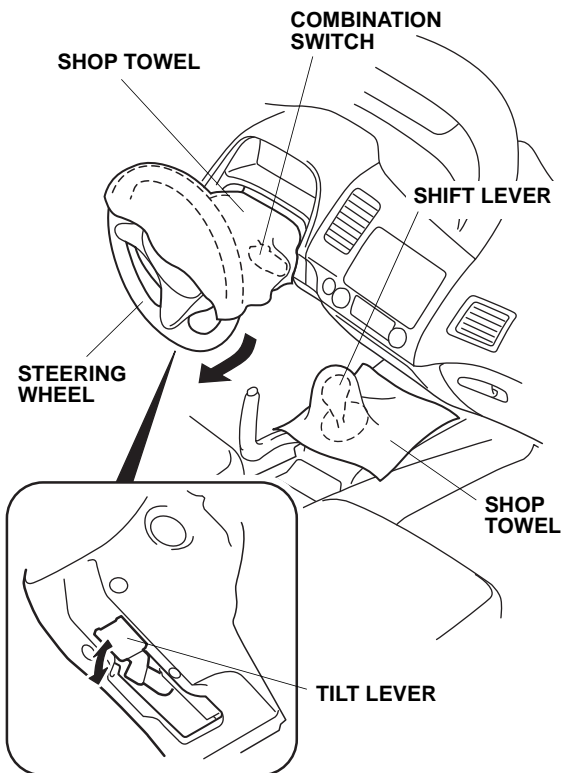

- To protect the dashboard area, put shop towels over the steering wheel and shift lever.

- Apply masking tape to the meter panel as shown, and remove the meter panel (one self-tapping screw and 11 clips, and unplug the vehicle connectors).

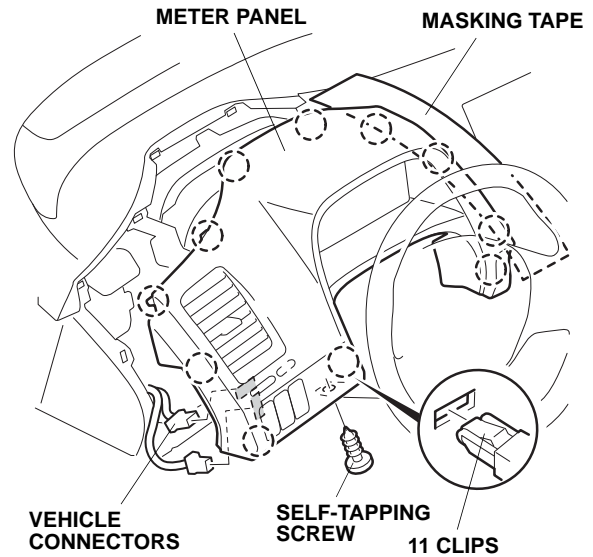

- Apply masking tape to the instrument panel as shown. Remove the center panel (two bolts, 11 clips, and aspirator hose, and unplug the vehicle connectors).

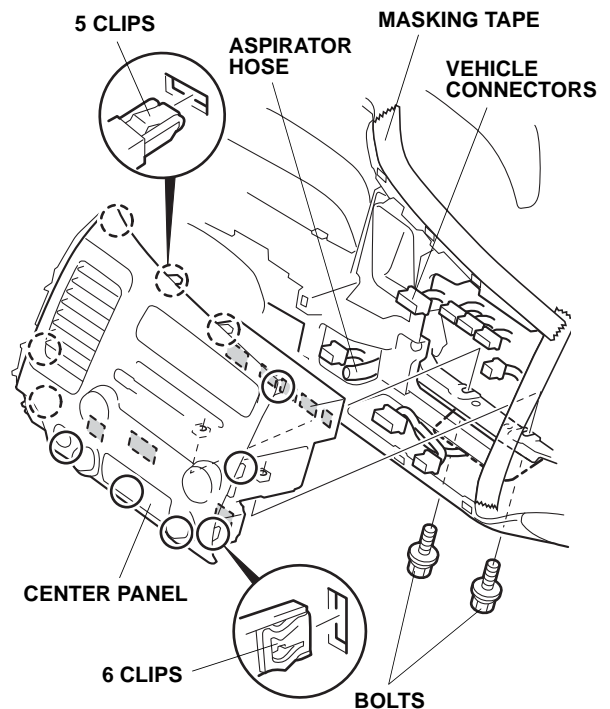

12. Pull the weatherstrip off in the area shown.

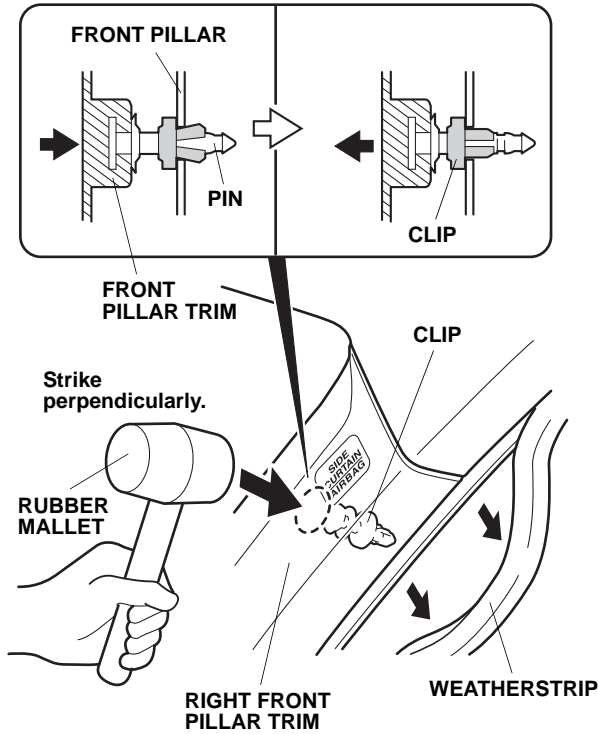

13. Push the clip into the vehicle side by striking the top of the right front pillar trim in the part marked as "SIDE CURTAIN AIRBAG" with the rubber mallet perpendicularly to the vehicle. Then, remove the clip.

14. Pull the weatherstrip off in the area shown. And remove the right front pillar trim (two clips).

4-door vehicle:

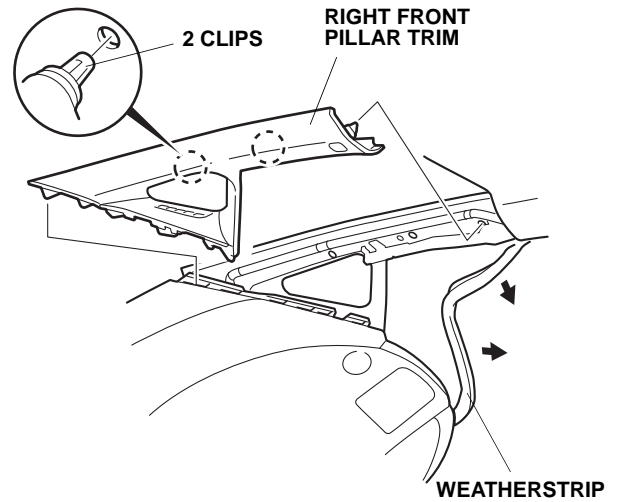

2-door vehicle:

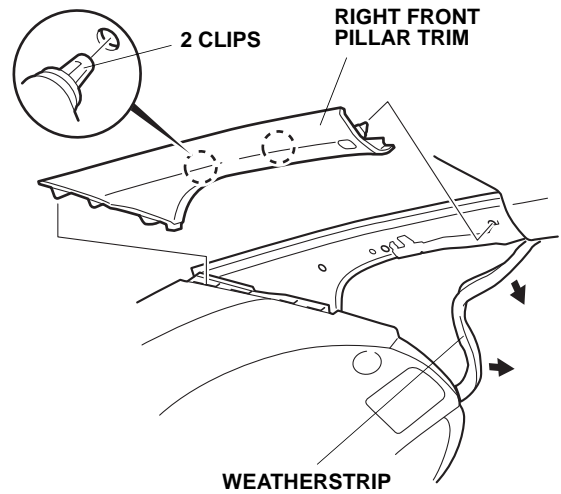

- Remove the cap from the right sunvisor (four retaining tabs).

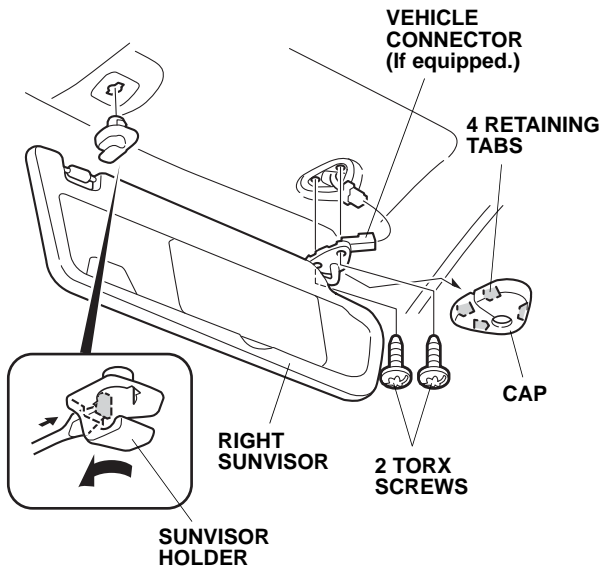

- Remove the right sunvisor (two T25 TORX screws, and unplug the vehicle connector, if equipped).
- Remove the sunvisor holder. Turn the holder 90°, then pull it out.
- Remove the center console cover.

A/T vehicle:

Remove the center console cover (five clips).

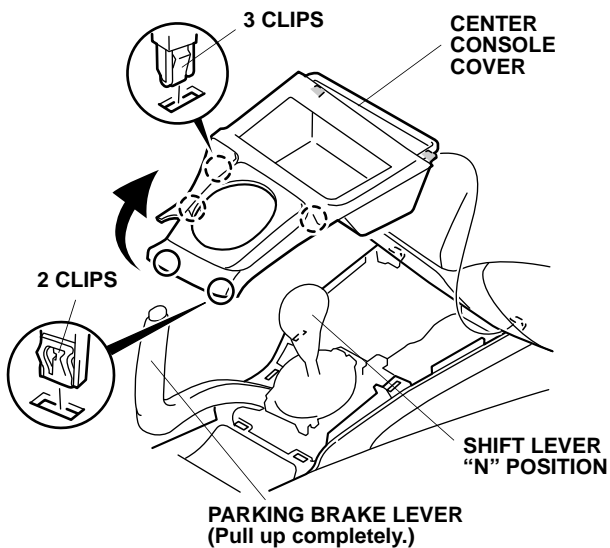

M/T Vehicle

- Pull down on the shift boot. Remove the shift knob by rotating counterclockwise.

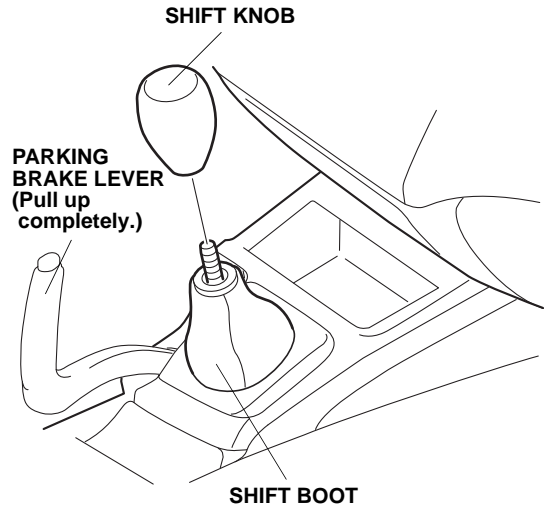

- Remove the center console cover (five clips).

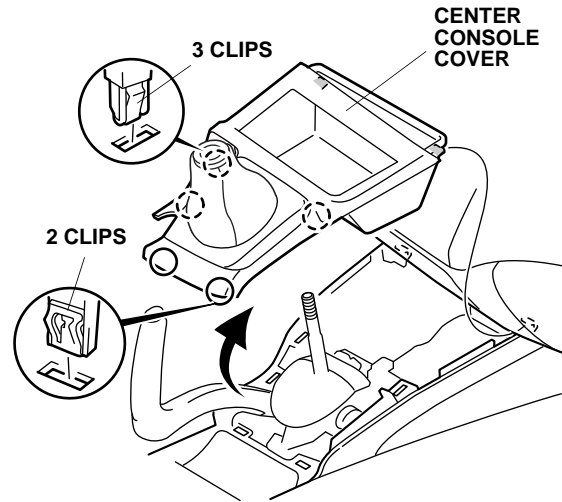

19. Open the center console lid, and remove the mat.

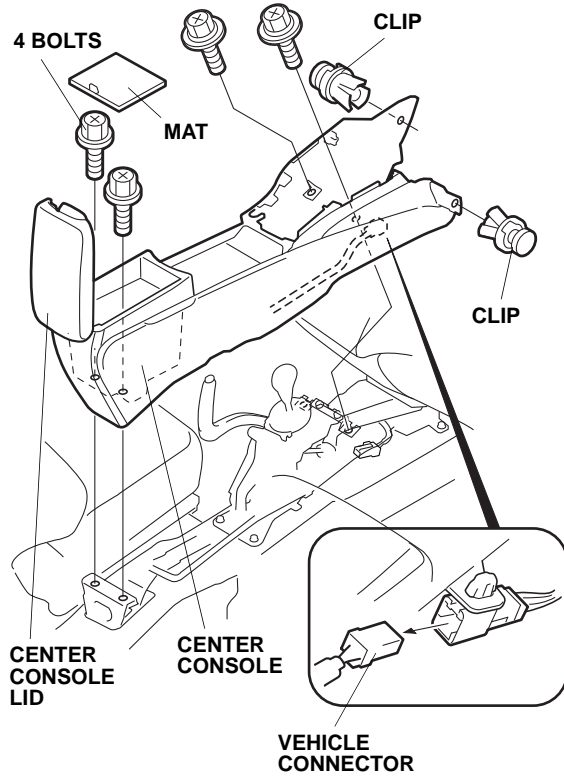

20. Remove the center console (four bolts and two clips, and unplug the vehicle connector).

- **2-door vehicle:** Go on to step 21.
- **4-door vehicle:** Go to step 26.

2-door vehicle:

21. In the passenger's compartment, remove the bolt and then rear seat cushion (two hooks).

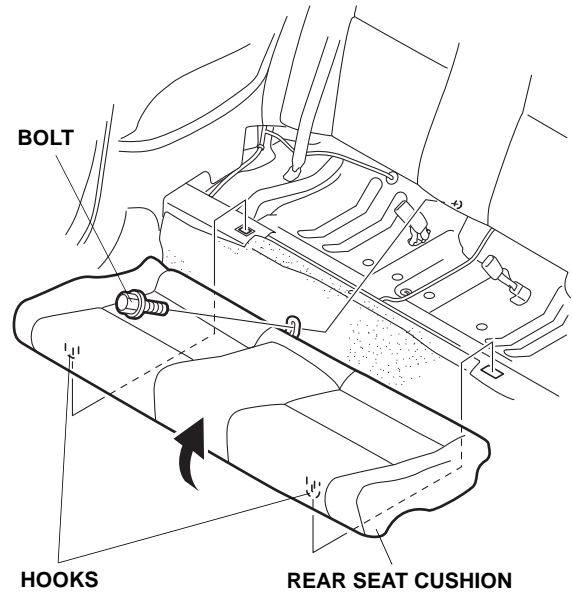

22. Open the trunk lid. Fold the rear seatback forward by pulling the levers under the rear shelf. Remove the trunk floor mat (two clips).

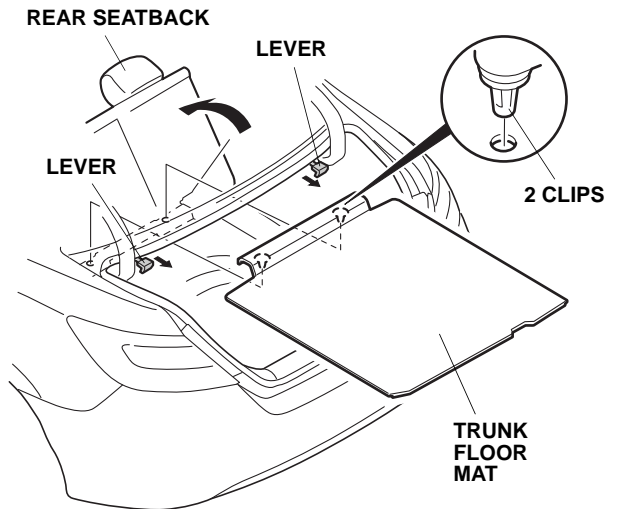

23. Pull the trunk weatherstrip off in the area shown.

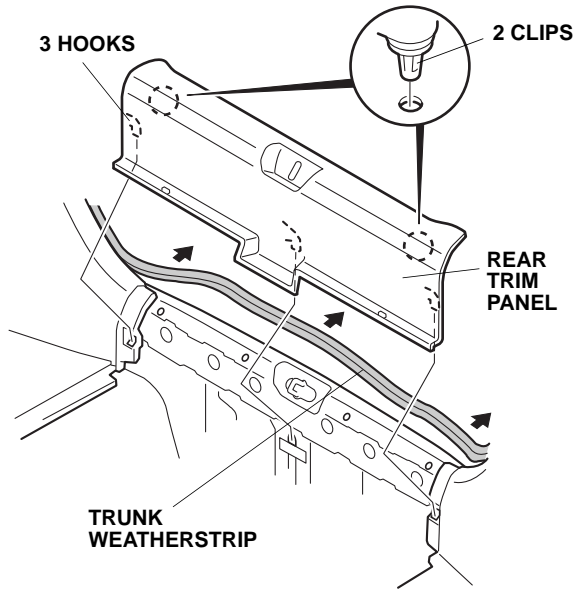

24. Remove the rear trim panel (two clips and three hooks).

25. Pull the weatherstrip off. Remove the five clips and then the right trunk side trim panel. Go to step 34.

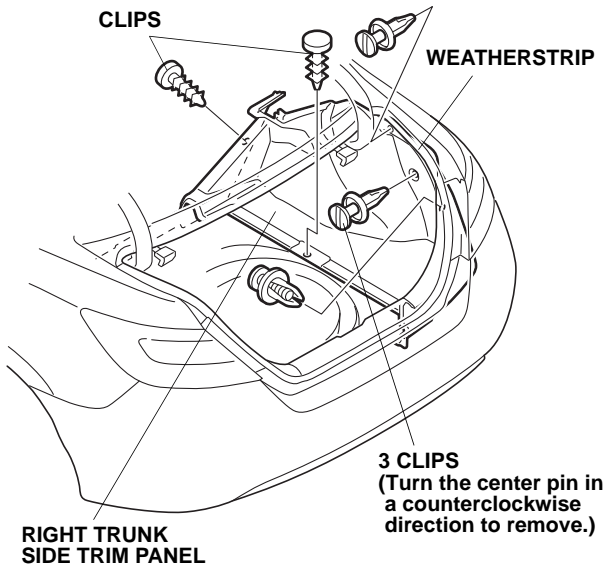

4-door vehicle:

26. Remove the bolt and then rear seat cushion (two hooks).

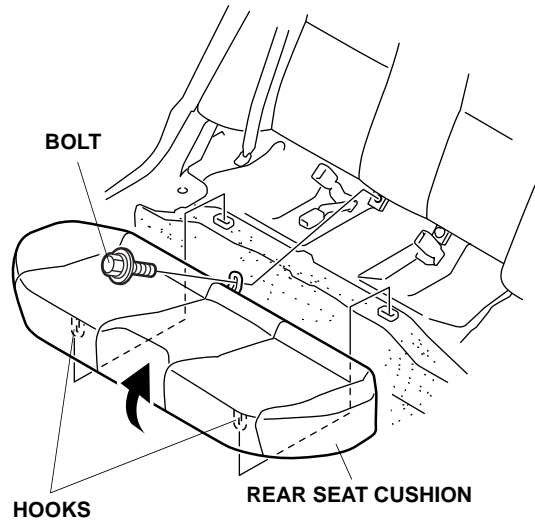

27. Remove the bolt and then the right seat side bolster.

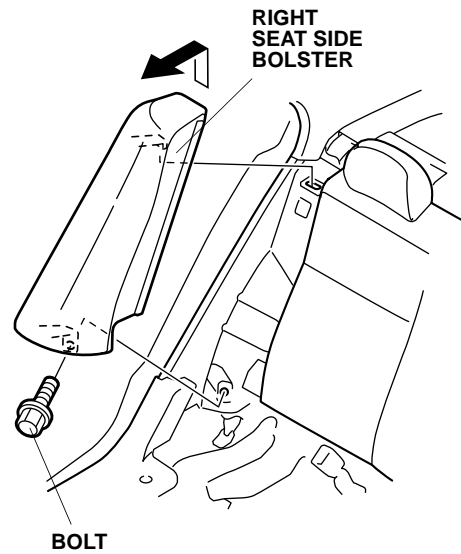

28. Remove the right rear side step trim (four clips and three retaining tabs).

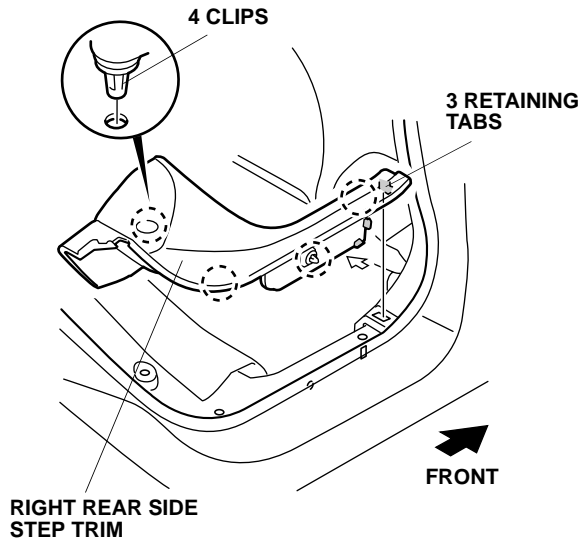

29. Open the trunk lid. Fold the rear seatback forward by pulling the levers under the rear shelf.

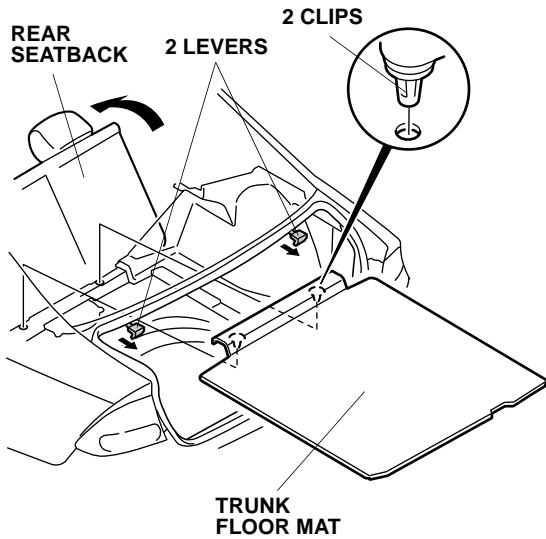

30. Remove the trunk floor mat (two clips).

31. Pull the weatherstrip off in the area shown.

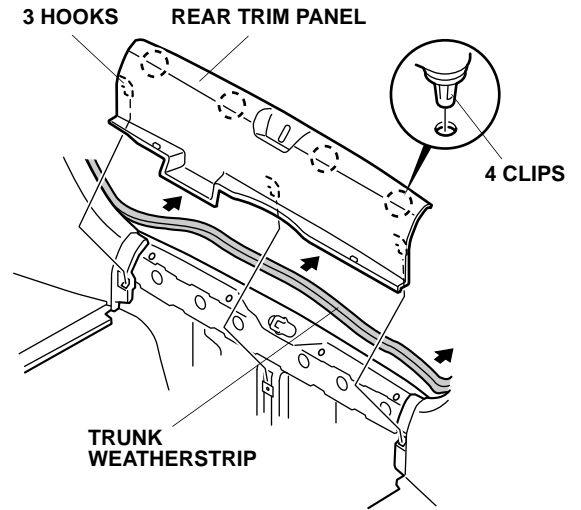

32. Remove the rear trim panel (four clips and three hooks).

33. Pull the weatherstrip off. Remove the five clips and then the right trunk side trim panel.

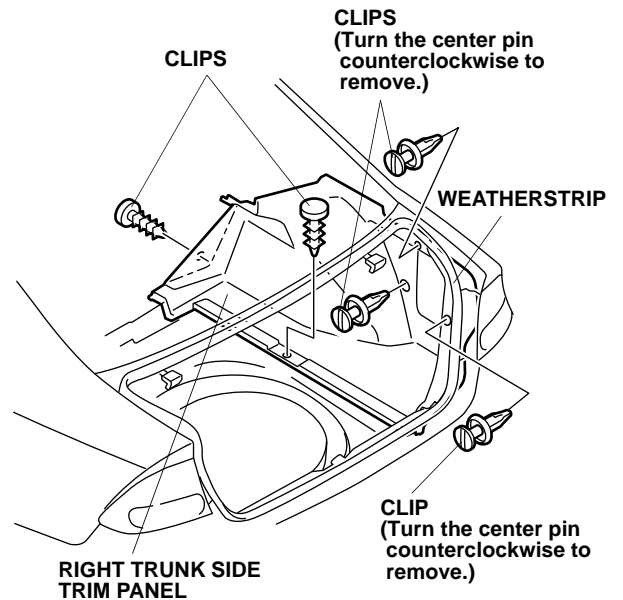

Routing the Bus Cable

34. Route the bus cable from the trunk as shown.

2-door vehicle:

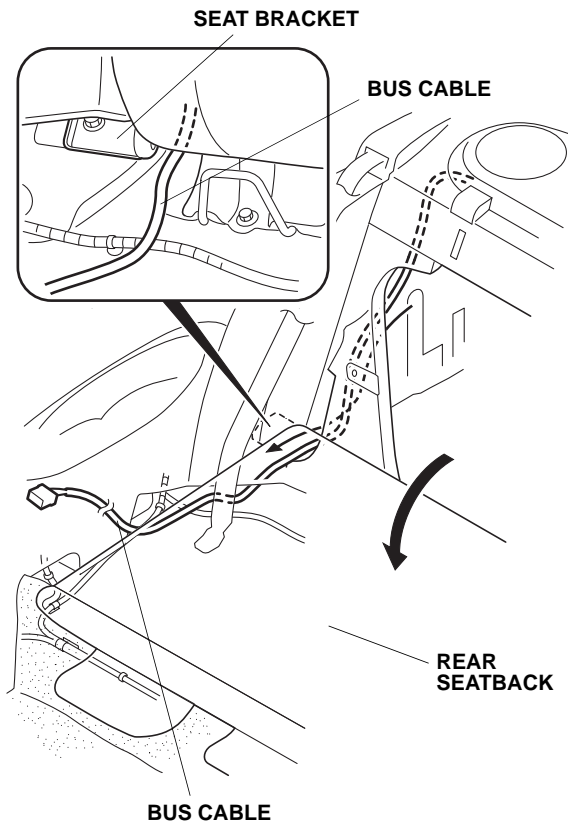

4-door vehicle:

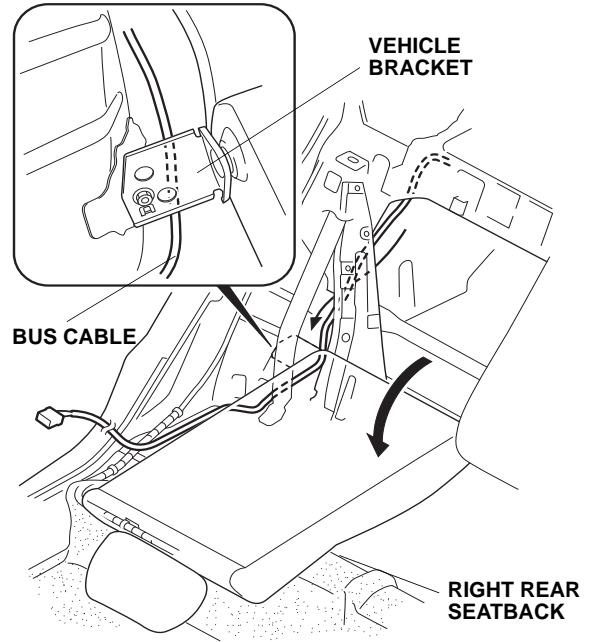

35. Lift up and lock the rear seatback, then remove the clip to pull back the floor carpet.

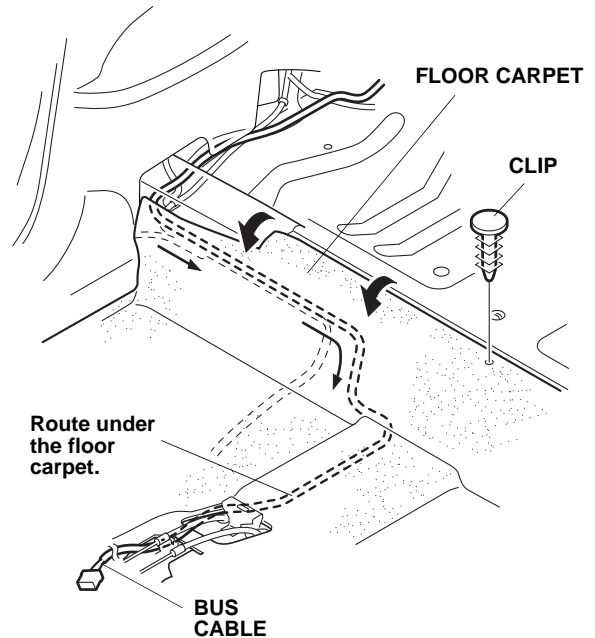

36. Route the bus cable forward under the floor carpet.

- Route the bus cable along the vehicle harness forward, then pull the bus cable connector out of the dash opening.

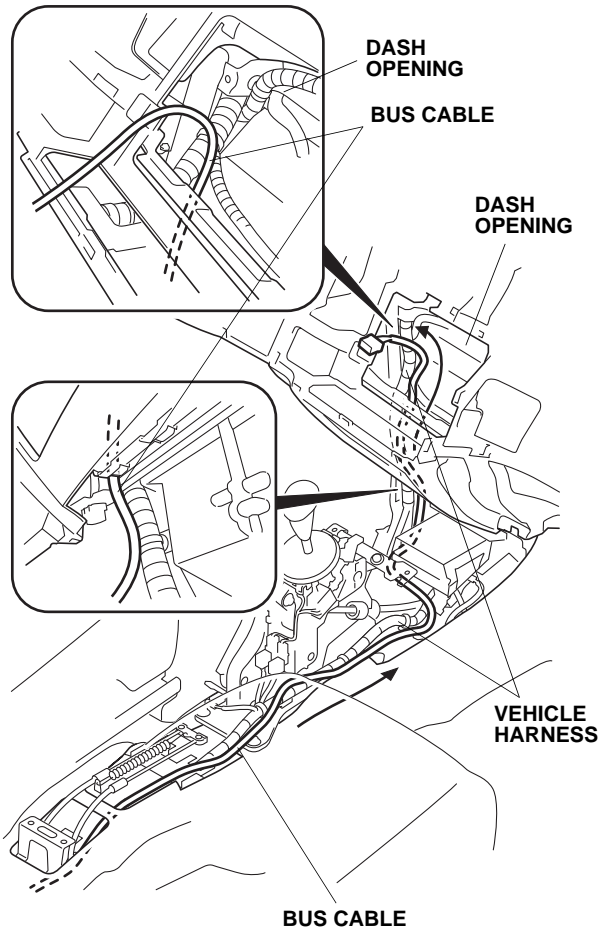

Routing the Antenna Cable

- With isopropyl alcohol on a shop towel, clean the area shown on the inside of the front window.

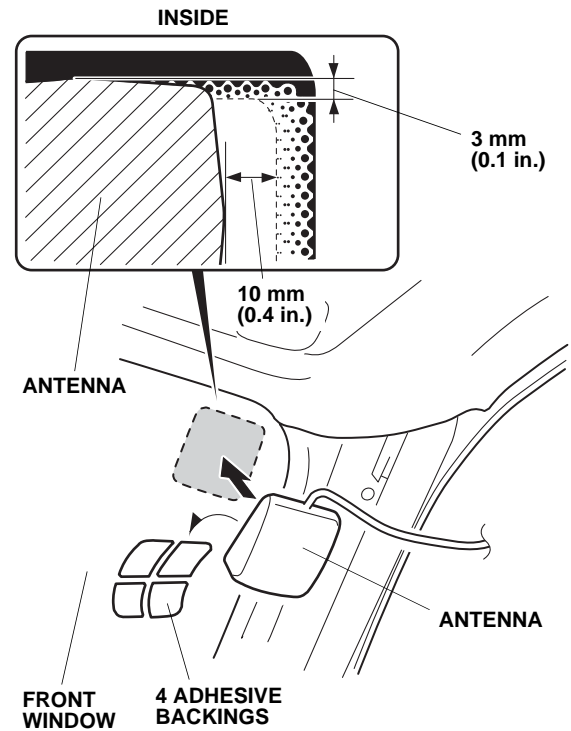

- Remove the adhesive backings from the antenna, and attach the antenna to the location shown. Apply sufficient pressure to completely contact.

40. Attach the masking tape to the location shown.

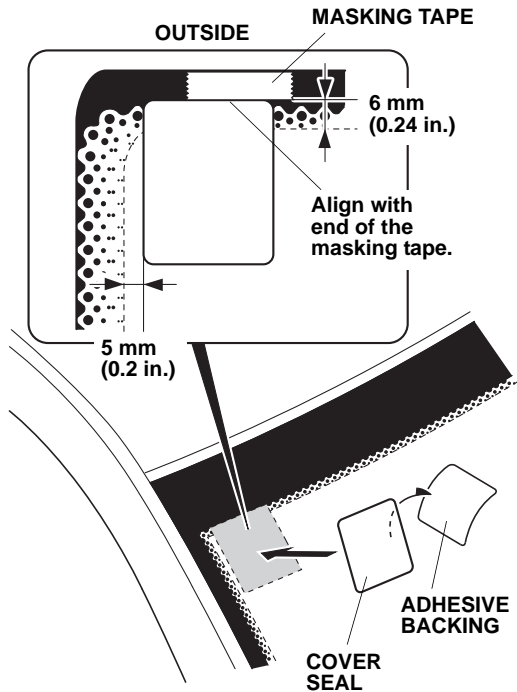

41. With isopropyl alcohol on a shop towel, clean the area shown on the outside of the front window.
42. Remove the adhesive backing from the cover seal, then attach to the location shown. Remove the masking tape.

43. With scissors, cut three EPT sealers in half.

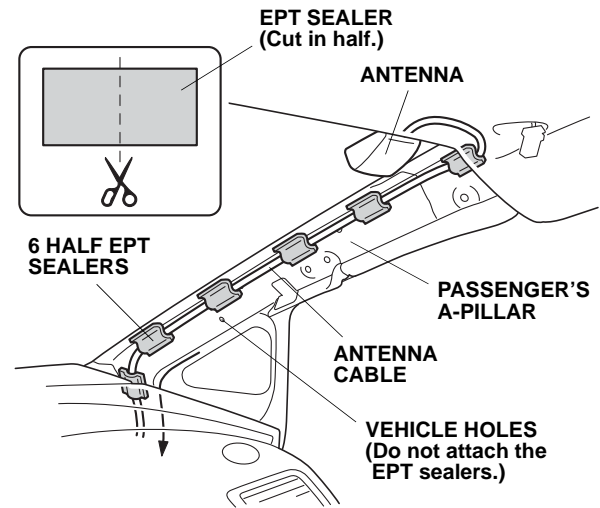

44. Route the antenna cable down along the passenger's A-pillar. Using the six pieces of EPT sealer, secure the antenna cable to the A-pillar panel in the areas shown.

NOTE: Do not attach the half EPT sealers to the vehicle holes, pay attention to the orientation of half EPT sealers.

- With scissors, cut one EPT sealer in half. Attach one of the halved piece of the EPT sealer to the vehicle bracket.

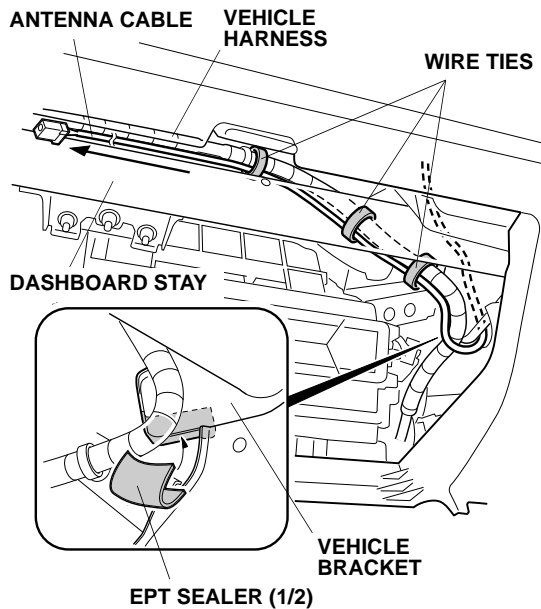

- Route the antenna cable down behind the dashboard stay and towards the glove box. Using three wire ties, secure the antenna cable to the vehicle harness.
- In the glove box opening, route the antenna cable along the vehicle harness and towards the audio unit opening.

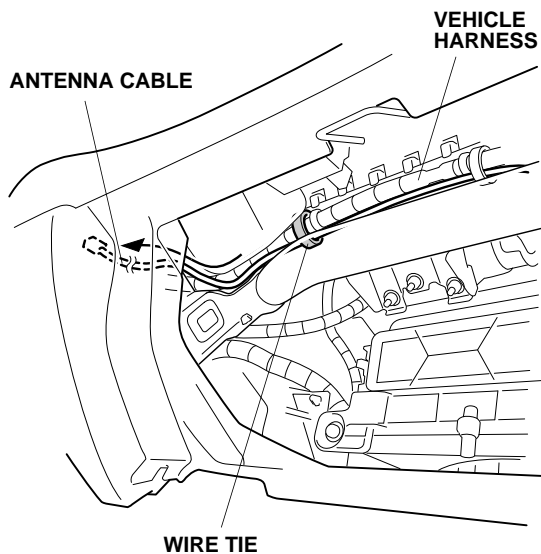

- Using one wire tie, secure the antenna cable to the vehicle harness.

- Route the antenna cable down along the bus cable as shown.

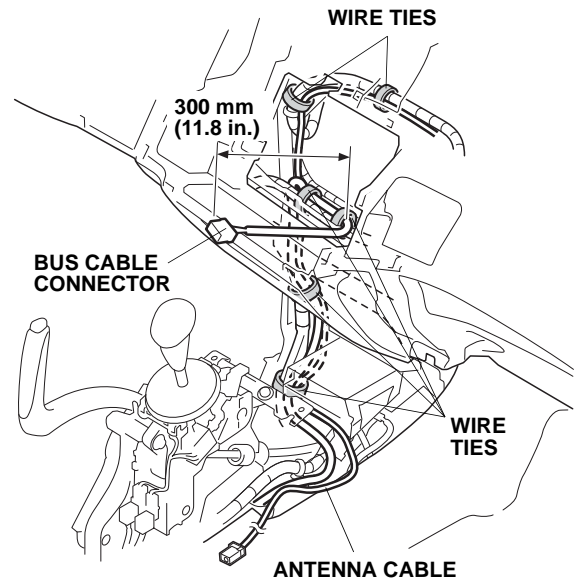

- Using six wire ties, secure the bus cable and antenna cable to the vehicle harness as shown.
- Route the antenna cable along the bus cable. Using three wire ties, secure the bus and antenna cables to the vehicle harness.

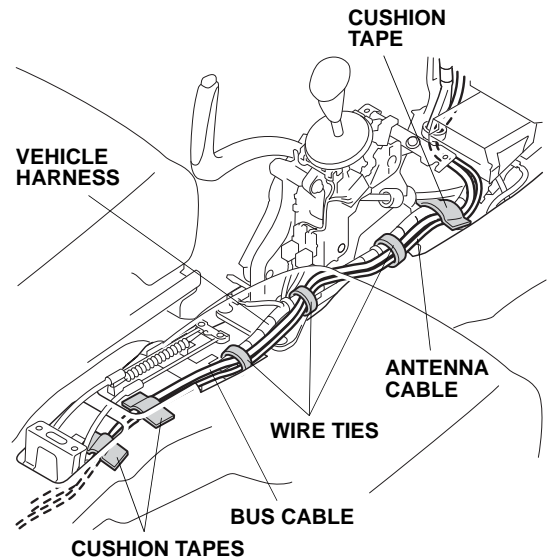

- Secure the bus and antenna cables to the floor panel using three cushion tapes in the areas shown after thorough cleaning with isopropyl alcohol on a shop towel.
- Route the antenna cable along the bus cable. Turn over the floor carpet. Using two cushion tapes,

secure the bus and antenna cables to the floor panel in the areas shown after thorough cleaning with isopropyl alcohol on a shop towel.

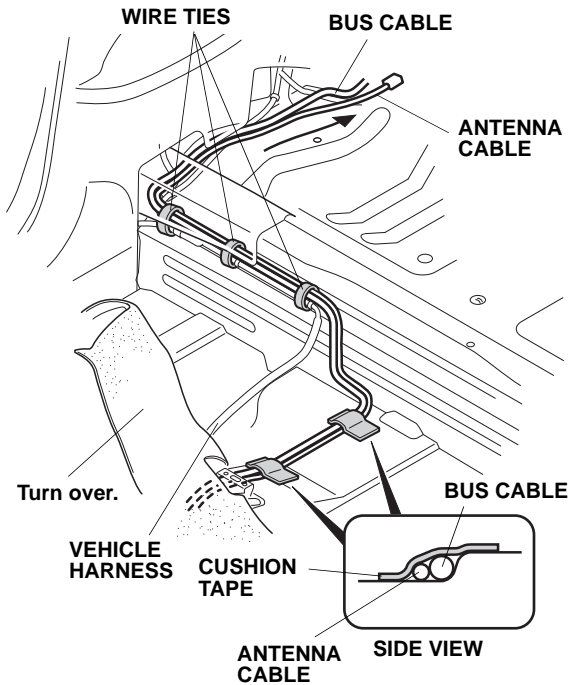

54. Using three wire ties, secure the bus and antenna cables to the vehicle harness in the areas shown.
- **2-door vehicle: Go on to step 55.**
 - **4-door vehicle: Go to step 57.**

2-door vehicle:

55. Route the antenna cable along the bus cable. Using the two wire ties, secure the bus and antenna cables to the vehicle harness in the areas shown.

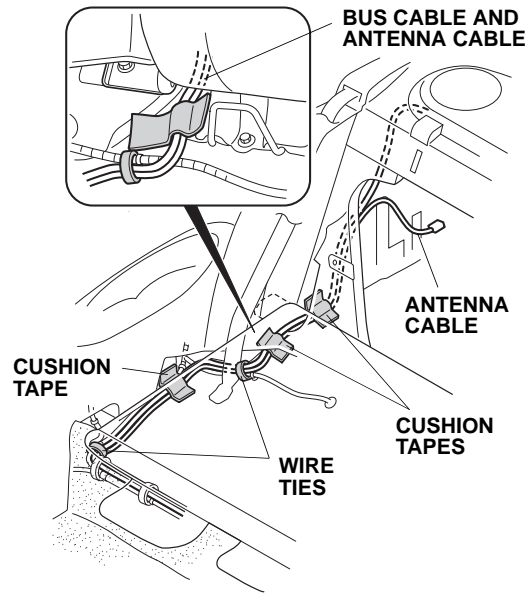

56. Using three cushion tapes, attach the bus and antenna cables to the floor panel in the areas shown after thorough cleaning with isopropyl alcohol on a shop towel. Go to step 59.

4-door vehicle:

57. Route the antenna cable along the bus cable. With two wire ties, secure the bus and antenna cables to the vehicle harness in the areas shown.

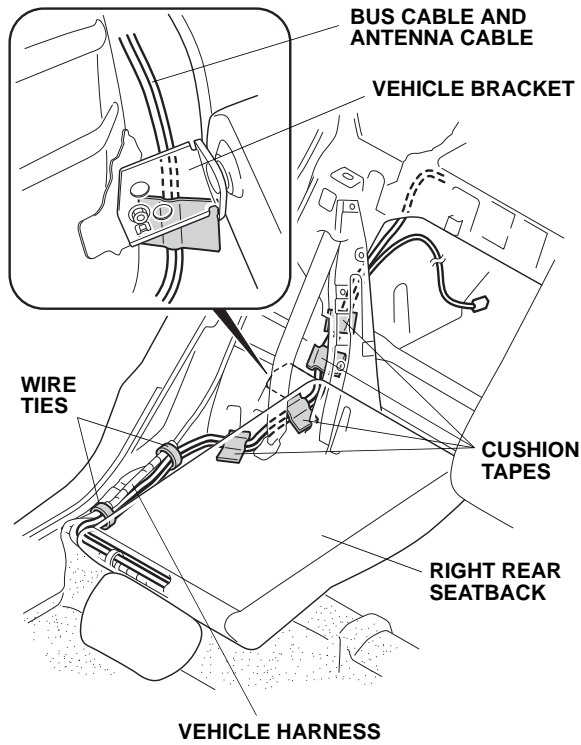

58. With four cushion tapes, secure the bus and antenna cables to the floor panel in the areas shown after thorough cleaning using isopropyl alcohol on a shop towel.

59. Attach EPT sealers to the right trunk inner panel in the areas shown after thorough cleaning using isopropyl alcohol on a shop towel.

2-door vehicle:

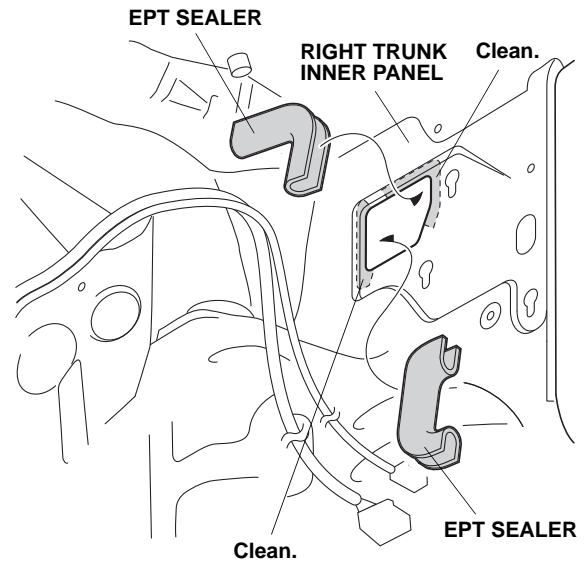

4-door vehicle:

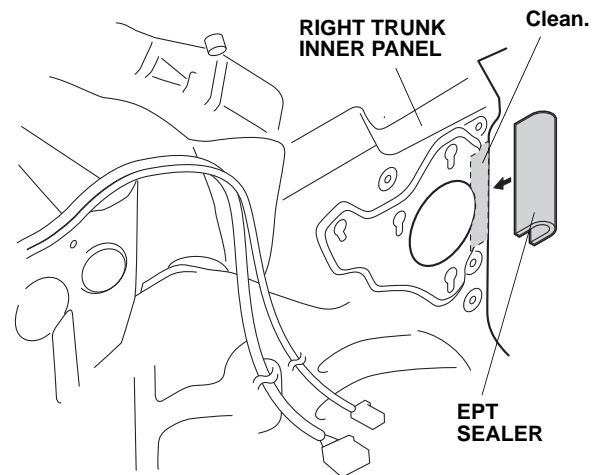

Installing the XM Radio Unit

60. Using four pan screws and four washers, set the front and rear brackets to the XM radio unit.
- **2-door vehicle: Go on to step 61.**
 - **4-door vehicle: Go to step 70.**

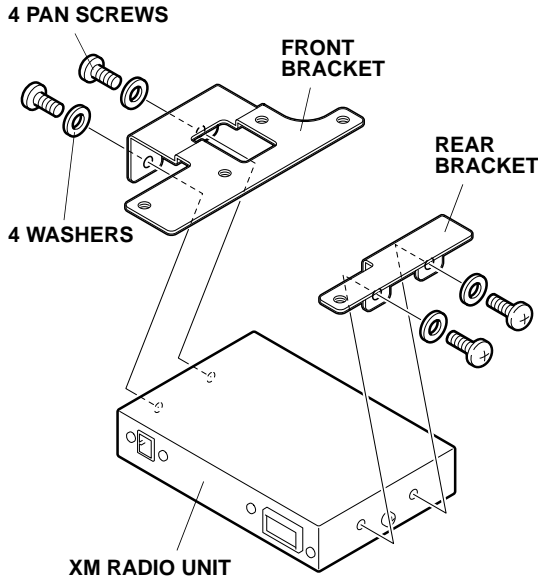

2-door vehicle:

61. Route the bus and antenna cables through the hole of the right trunk inner panel.

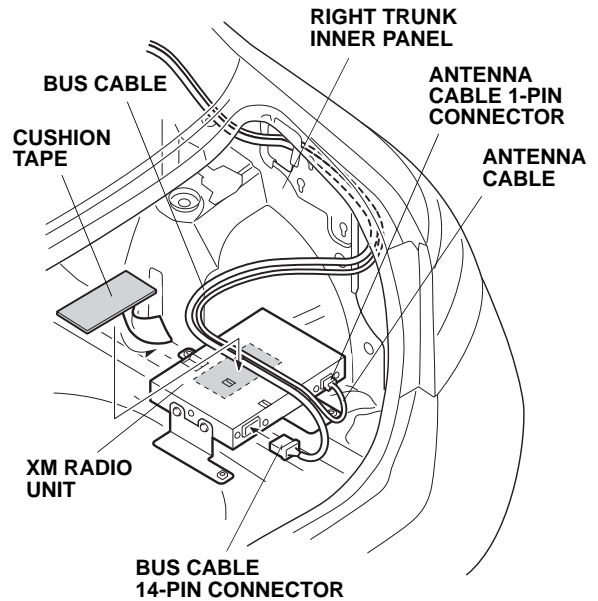

62. Plug the bus cable connector and the antenna cable connector into the XM radio unit.
63. Using one cushion tape, secure the bus and antenna cables to the XM radio unit.

64. Loosely tighten three flange bolts to the front and rear brackets. On the front bracket, use the "B" marked holes.

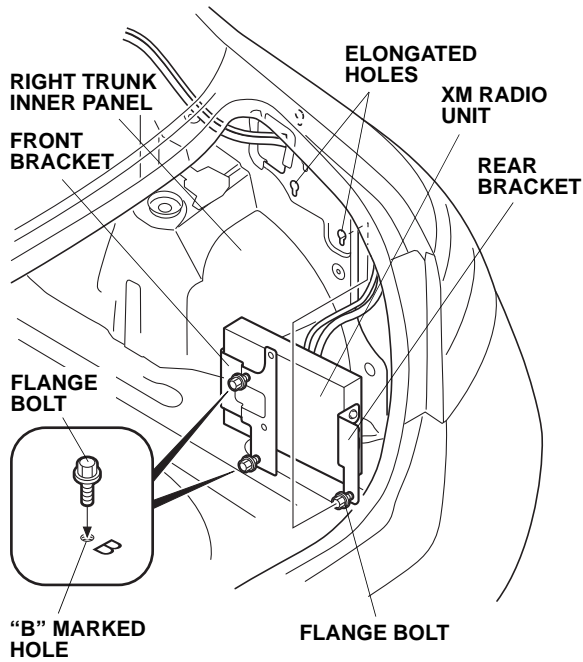

65. Place the XM radio assembly to the back of the right trunk inner panel. Set the three flange bolts into the elongated holes in the body panel.
66. Tighten the three flange bolts to secure.

67. Using one wire tie with clip, secure the bus and antenna cables in the area shown.

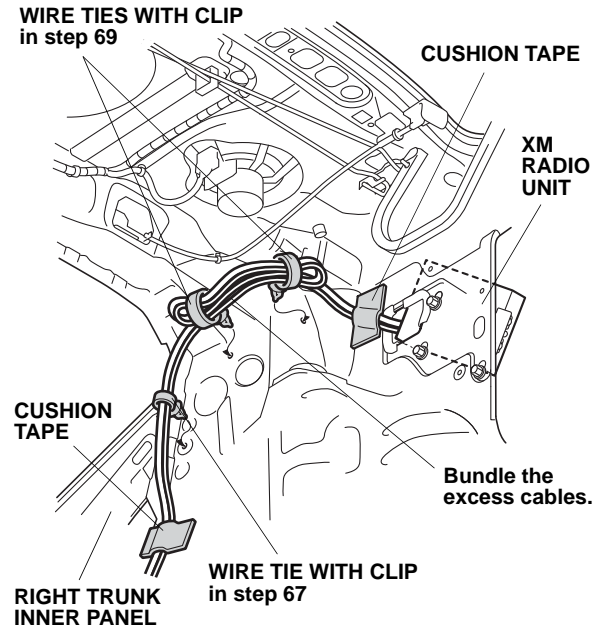

68. Using two cushion tapes, secure the bus and antenna cables to the right trunk inner panel in the area shown after thorough cleaning with isopropyl alcohol on a shop towel.
69. Using two wire ties with clip, bundle the excess of the bus and antenna cables, then tighten securely. Go to step 78.

4-door vehicle:

70. Plug the bus cable connector and the antenna cable connector into the XM radio unit.

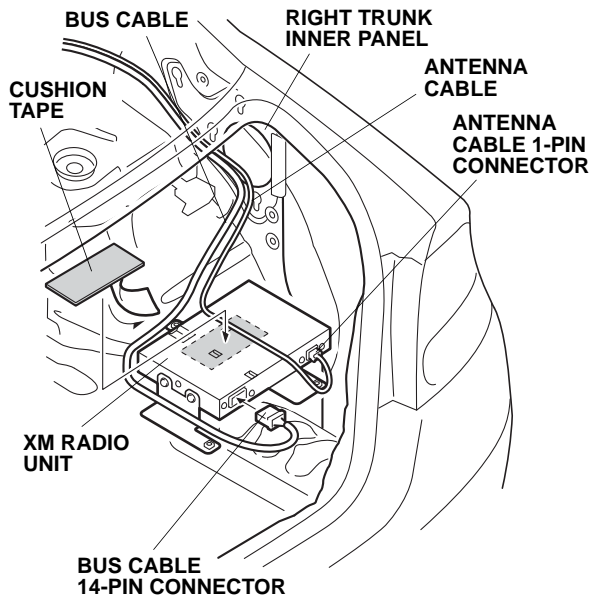

71. Using one cushion tape, secure the antenna cable to the XM radio unit in the area shown.
72. Loosely tighten three flange bolts to the front and rear brackets. On the front bracket, use the "A" marked holes.

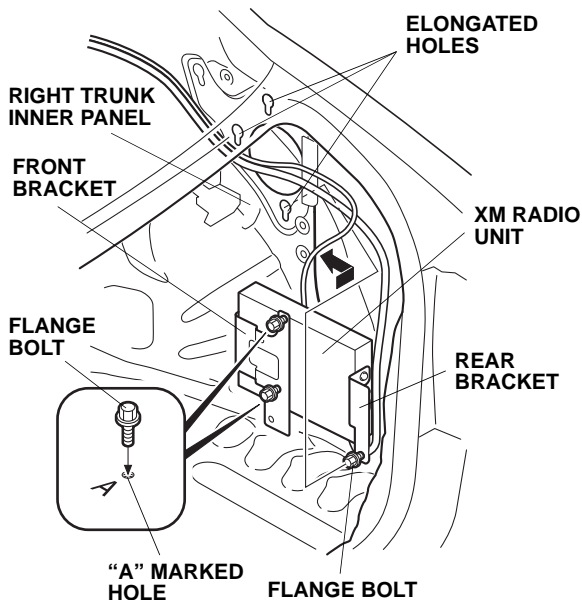

73. Place the XM radio assembly to the back of the right trunk inner panel. Set the three flange bolts into the elongated holes in the body panel.
74. Tighten the three flange bolts to secure.

75. Using one wire tie with clip, secure the bus and antenna cables in the area shown.

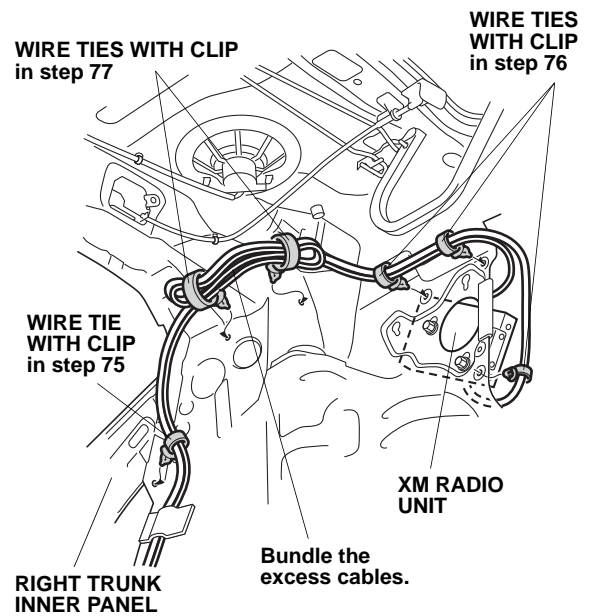

76. Using three wire ties with clip, secure the bus and antenna cables to the holes on the right trunk inner panel.
77. Using two wire ties with clip, bundle the excess of the bus cable and antenna cables, then tighten securely.

If the vehicle you're working on is equipped with CD Changer, go on to step 78; otherwise, go to step 80.

78. Plug the 2-port bus cable connectors in the two bus cables.

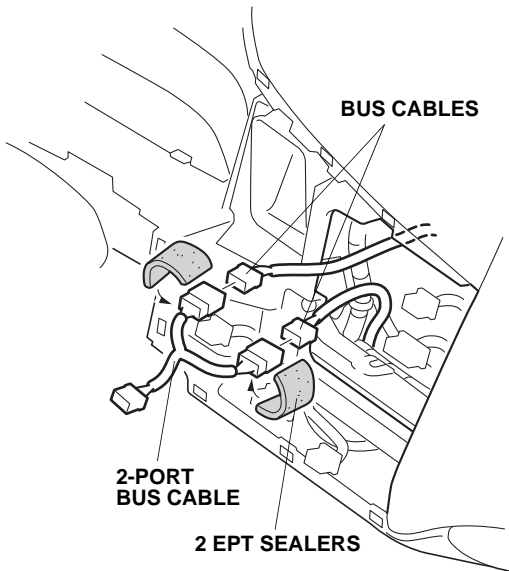

79. Attach two EPT sealers around the two plugged connectors.

80. Plug the bus cable connector into the audio unit.

Audio Unit for 4-door vehicle

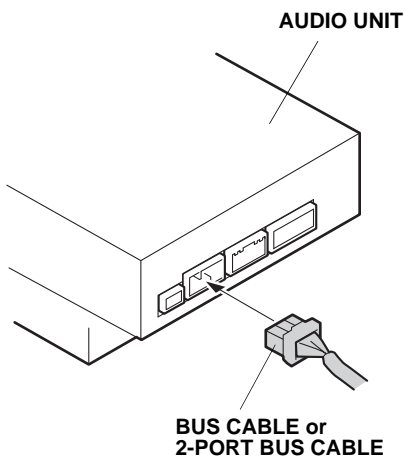

Audio Unit for 2-door vehicle

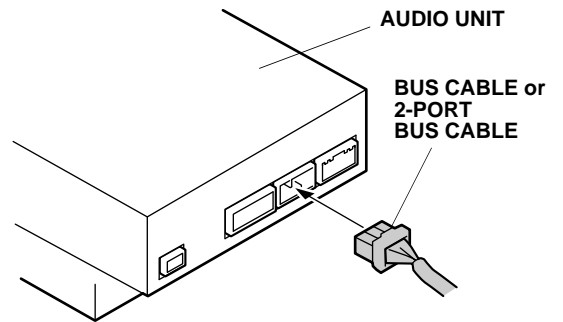

Navigation Unit

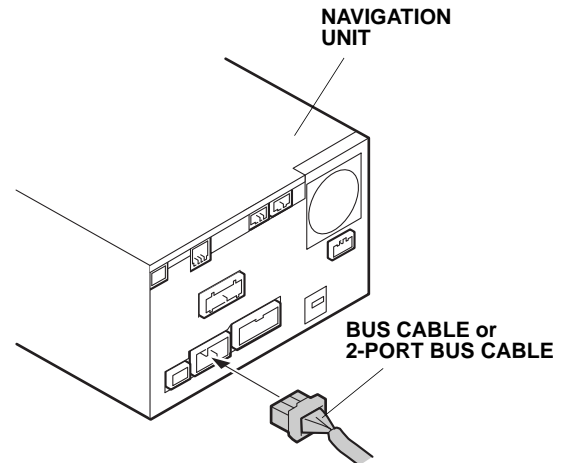

81. Plug the vehicle connectors to the center panel, and reinstall the center panel.

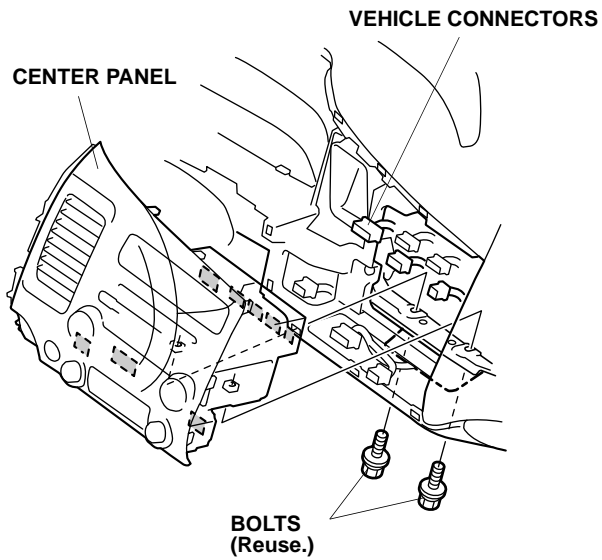

82. Replace the old clip on the right front pillar trim with a new one.

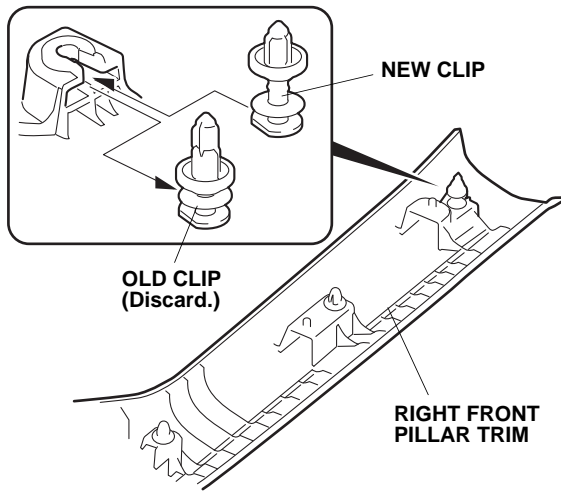

83. Check that all wire harnesses are routed properly and all connectors are plugged in.
84. Reinstall all removed parts.
85. Connect the negative cable to the battery and check operation of all lights and other electrical accessories.
86. Enter the anti-theft codes for the audio system and the navigation system (if equipped), and reset the radio station presets.
87. Reset the clock on vehicles without navigation.
88. Check the operation of the XM radio system according to the vehicle's owner's manual.